



**“The one you
install in less
than an hour.”**

DoorCatalog

In this brochure you will find a comprehensive guide to all the possible options of our door sets and hardware.



Strongdor is a steel door and frame manufacturer offering a doorset as a complete package.

Our Patent-Pending frame system features adjustable anchors, and all hardware comes pre-installed. Plus, you won't need to hire a painter or remove and re-install hardware!

Save time and money with our quick-install door frame and hardware system. The Strongdor system can typically be installed in less than an hour.



What our customers are saying about us!

“
Incredible!
”

“
This is
going
to save
us hours!
”

“
Innovative!
”

“
Eye-popping!
”

“
It felt like we
were cheating,
because it
installed
so fast!
”

Does Strongdor import doors?

NO! Strongdor has built a state of the art manufacturing facility in Glendale Heights, Illinois USA. We manufacture all doors and frames right here in the USA.

Proud to be partnering with some of the best vendors from the USA to make this happen...

- US Manufacturing
- US Employees
- US Steel



What sets us apart?



Pre-Painted.

This isn't a primer, it's a high-quality, long-lasting finish color coating that outperforms traditional hand painting.

Choose from 18 standard colors. Thanks to our advanced quick-change powder booths, there are no minimum order requirements or setup charges.

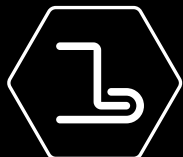

Built-In Astragal.

All Strongdor doors feature an integrated astragal as standard in the construction process, providing a full-height latch guard. This design not only protects against break-ins but also enhances the door's overall appearance.

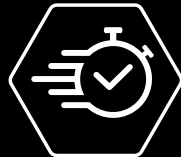

Fast Install.

Our Patent-Pending frame system features adjustable anchors, and all hardware comes pre-installed. Plus, you won't need to hire a painter or remove and re-install hardware!

Save time and money with our quick-install door frame and hardware system. The Strongdor system can typically be installed in less than an hour.



Pre-Hung.

All single doors come pre-hung in the frame to ensure that all hinge and latch locations are correctly aligned before shipping. We also pre-install gaskets, adjustable anchors, thresholds, and provide an installation kit with everything you need for a smooth installation.



No Minimum Order.

We specialize in fast delivery for small orders. Need just one door for the back of a shop? No problem. While we can also handle larger orders, we want you to know that no order is too small for Strongdor.



Pre-Installed Hardware.

(Options available)

Exit trims, locks, closers, kick plates, lite kits, louvers, and more can be pre-installed at our facility before the doors reach your jobsite. This eliminates the need for on-site hardware prep and ensures all hardware has been tested in our factory before shipping. We use Rivet Nuts instead of self-tapping fasteners, ensuring a more secure and durable installation that won't loosen over time.

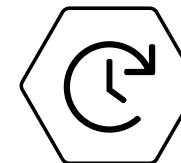

Short Lead Time.

At Strongdor, we've invested in advanced software systems, eliminating many of the manual processes used by other manufacturers. This automation enhances product quality, speeds up throughput times, and allows us to handle custom sizes and specifications at no extra cost!

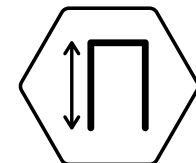

Custom Sizes.

Throughout the last 15 years, we have built our systems and software as well as refining our product meaning manufacturing custom sizes and specifications is standard to us!

Purchase a door that truly fits your space at no extra cost or lead-time!

Watch our overview video here



Step 1. Choose your door and hardware combination.

For all hardware combinations.

Every doorset and hardware combination includes: ball bearing hinges, threshold, gasket, adjustable anchors and sweep. All Doors are 18-gauge and frames are 16-gauge.

Single



Rim Exit (EO), Closer

Hardware
Type A
Type B



Rim Exit (with Entry Lever), Closer

Hardware
Type A
Type B



Rim Exit (with offset Pull and Cylinder), Closer

Hardware
Type A
Type B



Cylindrical Lock (Entry Function), Deadbolt, Closer

Hardware
Type A
Type B



Cylindrical Lock (Entry Function), Closer

Hardware
Type A
Type B



Mortise Lock (Entry Function), Closer

Hardware
Type A
Type B



Electrified Mortise Lock, Closer, EPT, Continuous Hinge

Hardware
Type A
Type B



Electrified Exit Device, Closer, EPT, Continuous Hinge

Hardware
Type B

Pair



Cylindrical Lock (Entry Function), Closers, Flushbolts

Hardware
Type A
Type B



Cylindrical Lock (Entry Function), Deadbolt, Closers, Flushbolts

Hardware
Type A
Type B



Rim Exit, Closers, Flushbolts

Hardware
Type A
Type B



SVR Exit, Closers

Hardware
Type A
Type B

Step 2. Choose your type of hardware.

To keep things simple, we have A and B.

Hardware Type A.

This is our most cost effective hardware option and utilizes brands such as Philadelphia Hardware Group (PHG), and Hager. Finishes are usually 26D and hardware at least Grade 2. All closers are powered to suit the size of door.

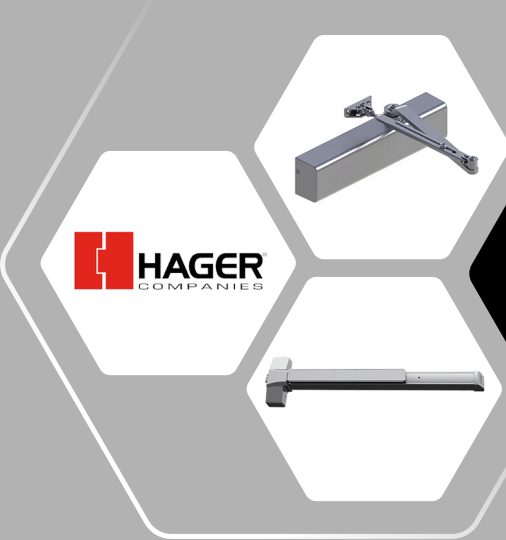

Hardware Type B.

This is our best selling hardware category utilizing Hager Hinge Company for almost all options. All hardware is supplied in 32D Stainless and Closers are all Power 6. Hager has been a leading independent American Hardware manufacturer for over 175 Years.

Prep Only Door And Frame.

Strongdor may consider a prep-only hardware option for customers who are high-volume buyers or those looking to stock Strongdor products. This could include 161 door prep and latch preps in the frame, ideal for while using your own hardware solutions. This would be on a case-by-case basis after consultation with a Strongdor representative.

For detailed hardware lists see back of brochure.

Step 3. Up Charges

Single Door System

Make to Frame Width Greater than 40"
*Min width: 24", Max Width 54" - Widths are Manufactured Frame Width

Make to Frame Height Greater than 95"
*Min Height: 70", Max Height 98" - Widths are Manufactured Frame Width

Insulated Core, with Phenomenal R-Value Characteristics

Equal Pair Door System

Make to Frame Width Greater than 95"
*Min width: 46", Max Width 98" - Widths are Manufactured Frame Width

Make to Frame Height Greater than 95"
*Min Height: 70", Max Height 98" - Widths are Manufactured Frame Width

Insulated Core, with Phenomenal R-Value Characteristics

Frame & Hinge Options

5 3/4"
Jamb Depth

4"- 5 3/4"
Custom Jamb Depth

5 3/4" - 12"
Custom Jamb Depth

4 Hinge Option
*Default for doors over 86" height; available as an option for shorter doors

Fig 1.

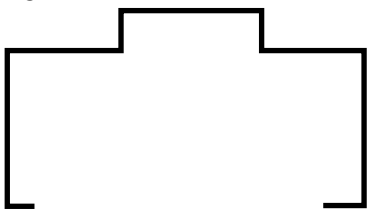

Double rabbet as standard.
Below 5 3/4" will be a single rabbet.

Fig 2.

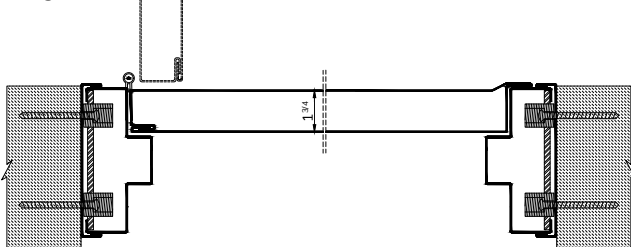

Built in security astragal.

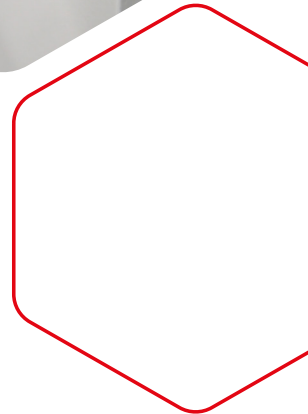
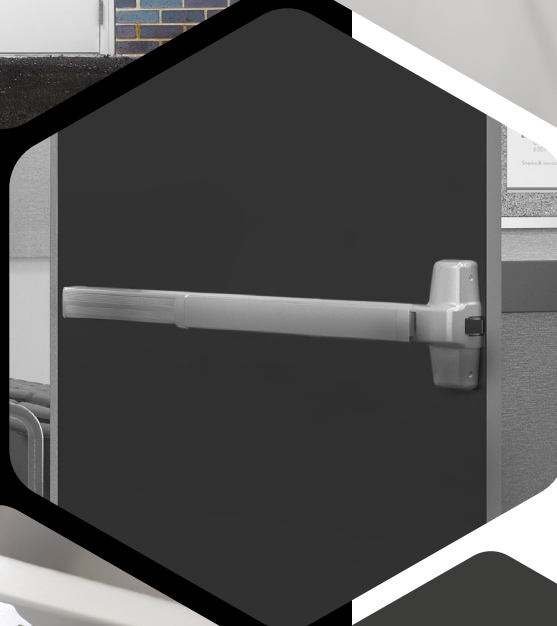

HOW TO ORDER.
Order size = Rough Opening Width minus 1/2" x Rough Opening Height minus 1/4"



Step 4. Choose Your Handing

● INDICATES KEY SIDE

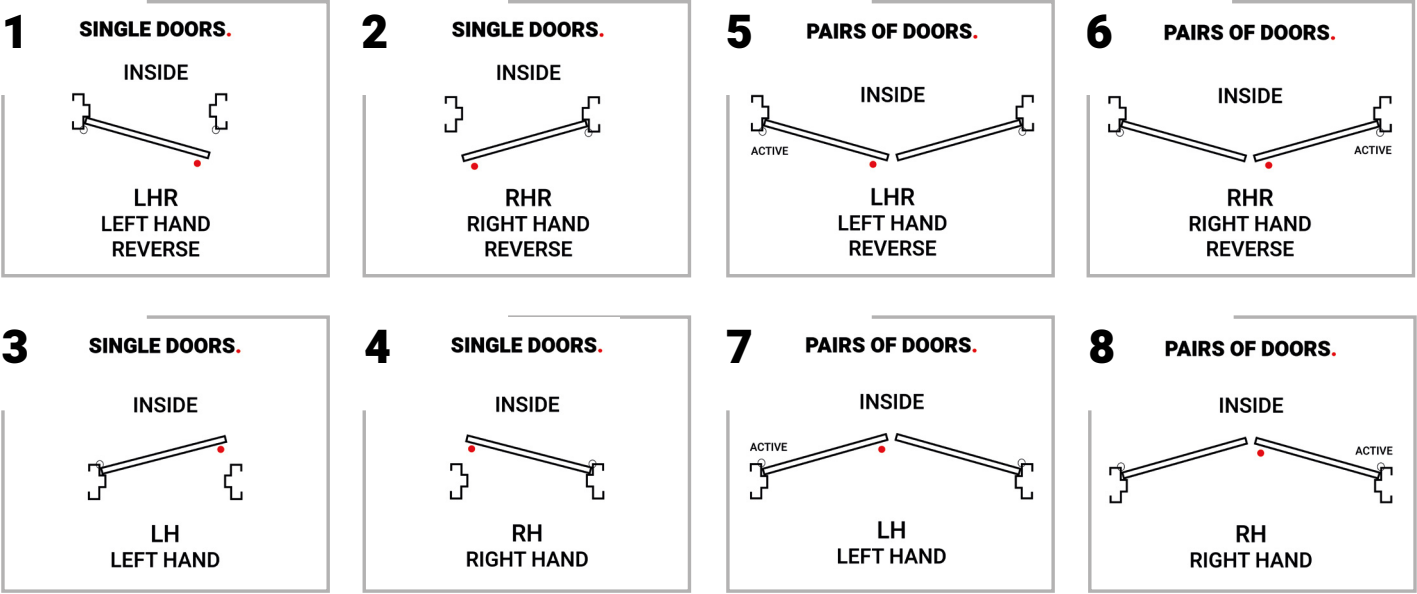

Step 5. Choose Your Color (Included)

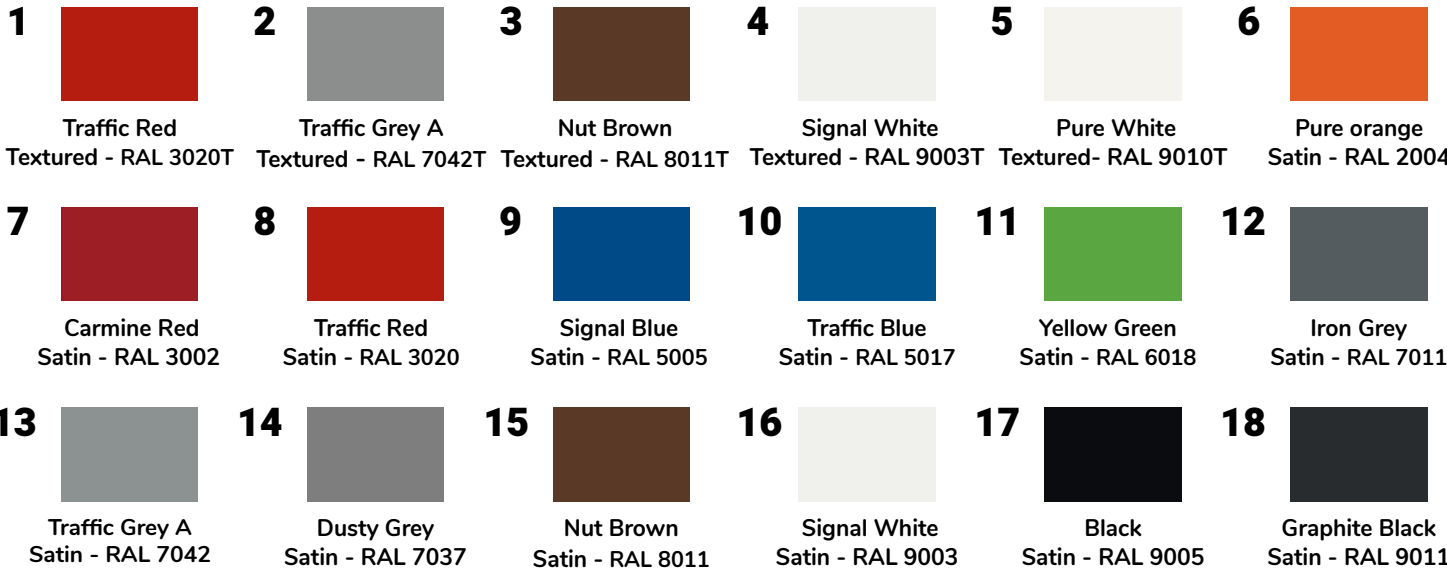

Other colors available for larger orders or regular use, please speak with a strongdor rep.



Standard Colors and Coatings.

To ensure maximum durability, Strongdor doors are supplied with a high-quality finish powder coating.

18 COLORS AVAILABLE.



Powder Coating **vs** Wet Paint.

Quantitative stats comparing a powder-coated
A60 Galvanneal door to a wet-painted cold rolled steel door:

Metric	Powder-Coated A60 Galvanneal	Wet-Painted Cold Rolled Steel
Estimated Lifespan	20	8
Maintenance Frequency (per 10 yrs)	1	4
Corrosion Resistance (1-10 scale)	9	4

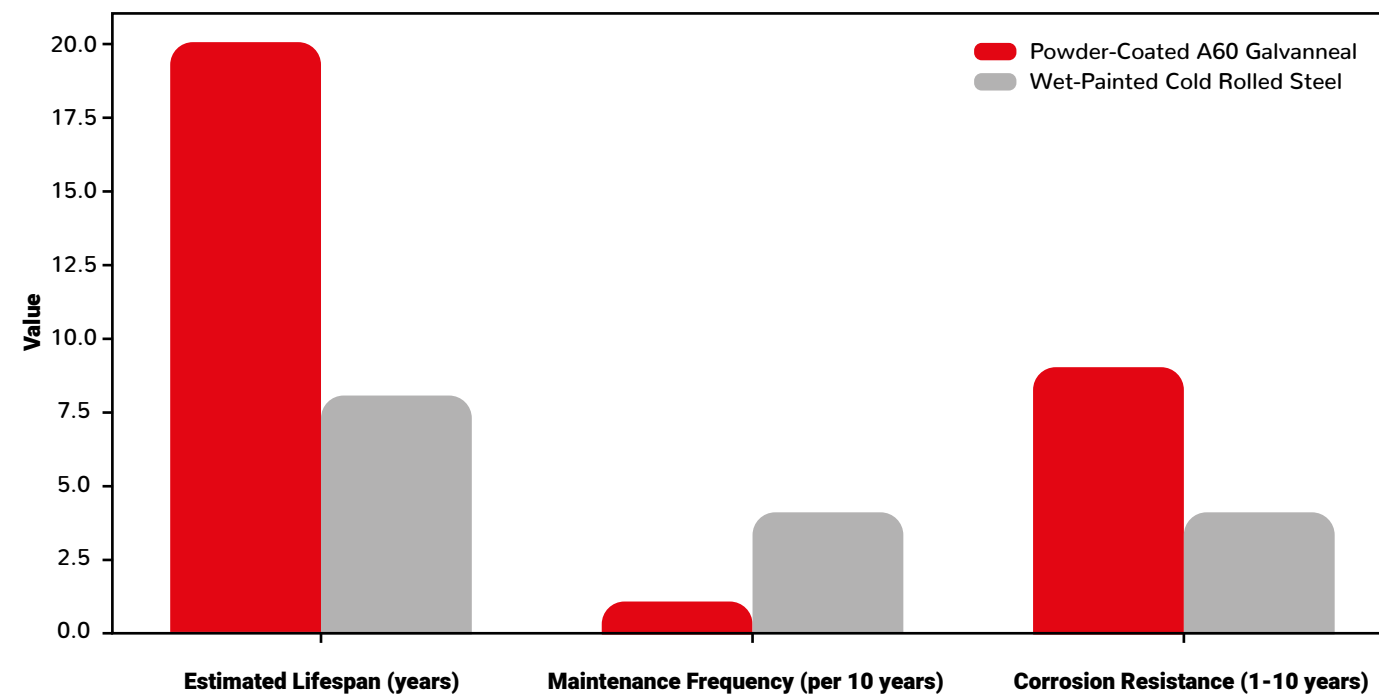

Maintenance frequency reduced by **80%** | Estimated Lifespan **140%** Greater Than Traditional Paint

Material Comparison.

Feature	A60 Galvanneal	Cold Rolled Steel
Corrosion Resistance	✓ Excellent	✗ Poor (Uncoated)
Paint Adhesion	✓ Superior	✗ Requires Prep
Weldability	✓ Clean & Safe	✓ Good
Formability	✗ Slightly Brittle	✓ Excellent
Longevity (Exterior Use)	✓ Long-Lasting	✗ Needs Protection

A60 Galvanneal is preferred for durability, corrosion resistance, and paint performance.

Optional Hardware Options.

Product code	Product Name
H1	Electric Strike – For Cylindrical Lock
H2	Camden CX-EPD1289L Electric Strike - For Rim Exit
H3	Continuous Hinge
H4	Rockwood 1700 Coordinator Bar
H5	Securitron DPS-M-BK Door Position Switch

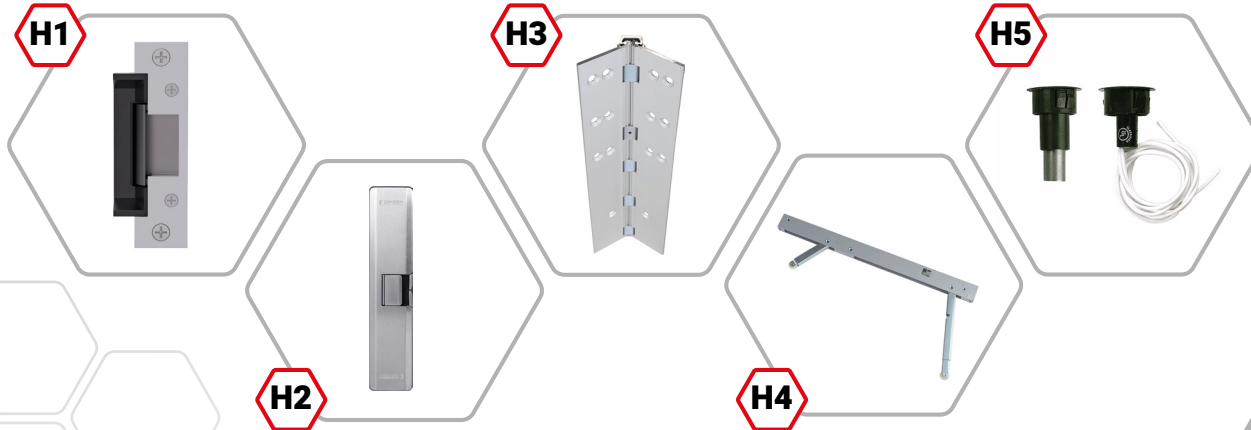

Add a Lite Kit Option.

ALL GLASS IS 1/4" CLEAR TEMPERED, ALL SIZES ARE CUTOUT SIZE

Product code	Product Name
LK1	5"W X 35"H X B Lite Kit
LK2	7"W X 22"H X B Lite Kit
LK3	8"W X 32"H X B Lite Kit
LK4	12"W X 12"H X B Lite Kit
LK5	24"W X 32"H X B Lite Kit

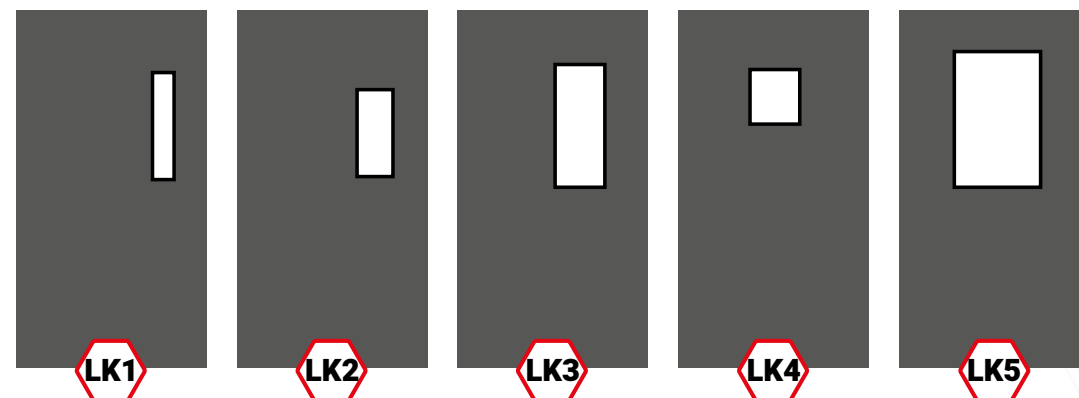

Add a Louver Kit Option.

Product code	Product Name
L1	12"W X 12"H Louver
L2	24"W X 12"H Louver
L3	18"W X 18"H Louver
L4	24"W X 24"H Louver

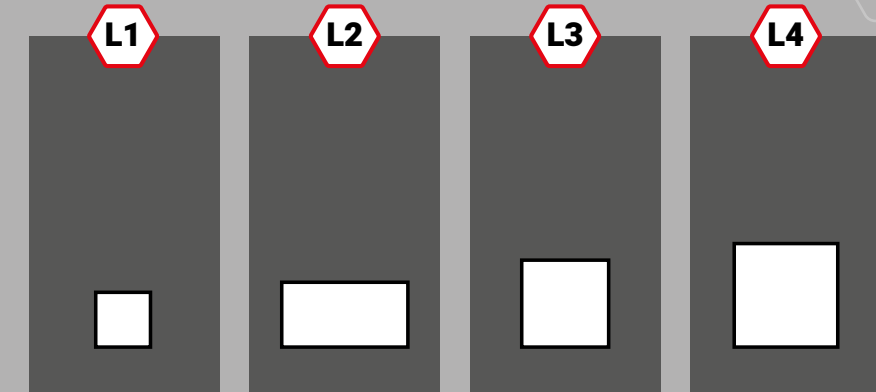

Add Accessory Options.

Product code	Product Name
A1	40"W Drip Cap (Supplied Loose)
A2	36" X 84" Pre-Installed Screw-on Weather Stripping
A3	10" Kick Plate, Pre-installed with Rivets
A4	34" Kick Plate Pre-installed with Rivets
A5	ABH 4423 Overhead Stop/Holder Surface Mount
A6	Door Viewer Pre-installed

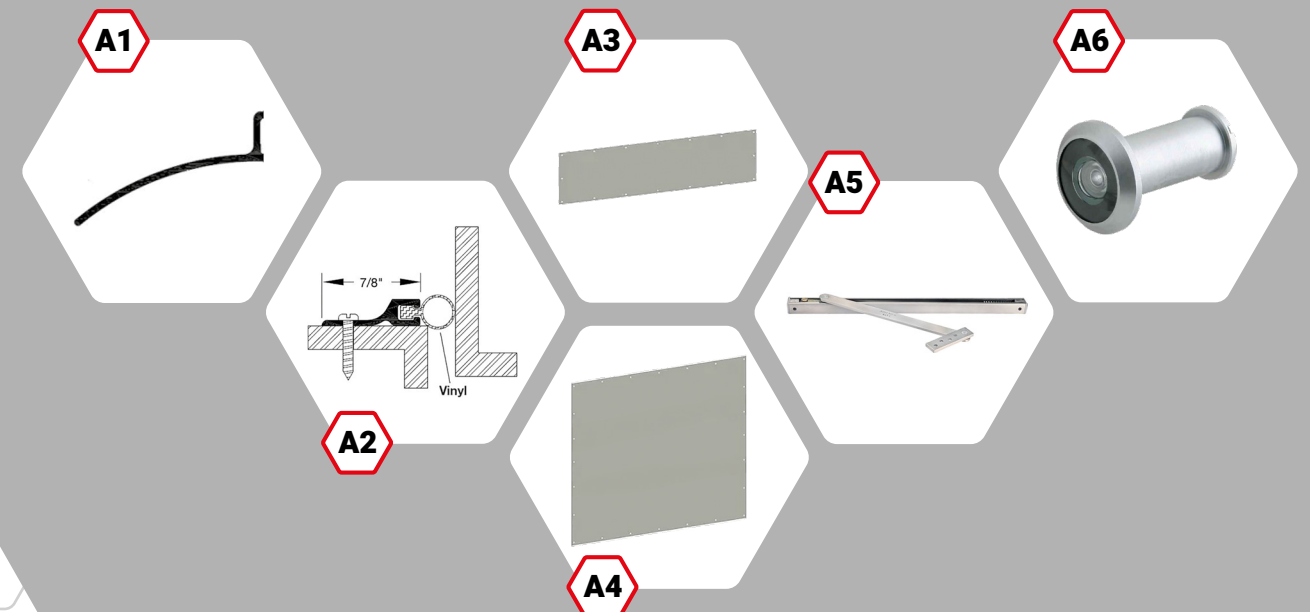

Index of Hardware Sets and Categories.

Hardware Pack No.	Item Description	Qty
1A	PHG 25EDR Exit Device	1
	PHG 4400 Closer	1
1B	Hager 4501 Rim Exit Device	1
	Hager 5200 X MLT X 1-6 X 5203 X FC Closer	1
2A	PHG 25EDR Exit Device	1
	PHG L900- ENTRY (F08) Exit Device Trim	1
	PHG 4400 Closer	1
2B	Hager 4501 Rim Exit Device	1
	Hager 45CE X WTN X 3902 X KD Exit Device Trim Only	1
	Hager 5200 X MLT X 1-6 X 5203 X FC Closer	1
3A	PHG 25EDR Exit Device	1
	Schlage 20-022.626 Rim Cylinder	1
	Trimco 1191-3 Pull	1
	PHG 4400 Closer	1
3B	Hager 4501 Rim Exit Device	1
	Schlage 20-022.626 Rim Cylinder	1
	Hager 12J Pull	1
	Hager 5200 X MLT X 1-6 X 5203 X FC Closer	1
4A	PHG HS500-ENTRY (F109) Cylindrical Lock	1
	PHG LU200 Cylindrical Dead Lock	1
	PHG 4400 Closer	1
4B	Hager 3453 X WITHNELL X 3944, SC X 3935 X KD X STD Cylindrical Lock with Thru Bolts	1
	Hager 3115 X 3940 X 3930 X KD Cylindrical Dead Lock	1
	Hager 5200 X MLT X 1-6 X 5203 X FC Closer	1
5A	PHG ES500-ENTRY (F109) Cylindrical Lock	1
	PHG 4400 Closer	1
5B	Hager 3453 X WITHNELL X 3944, SC X 3935 X KD X STD Cylindrical Lock with Thru Bolts	1
	Hager 5200 X MLT X 1-6 X 5203 X FC Closer	1
6A	PHG MSN704- Office Mortise Card Lock	1
	PHG 4400 Closer	1
6B	Hager 3853 X SECT X WTN X 3985 X KD Mortise Lock	1
	Hager 5200 X MLT X 1-6 X 5203 X FC Closer	1
7A	PHG MEN707EU Electric Mortise Lock	1
	PHG 4400 Closer	1
	Camden CM-PT516M Electric Power Transfer	1
	ABH A110HDC083 Continuous Hinge	1
	Hager 1-479-0038 Wiring Harness	1

Hardware Pack No.	Item Description	Qty
7B	Hager 3480EU X WITHNELL X 3944, SC X 3935 X KD X STD Electric Cylindrical Lock	1
	Hager 5200 X MLT X 1-6 X 5203 X FC Closer	1
	Hager 2-679-0623 Electric Power Transfer	1
	Hager 780-112HD X 83 OA Continuous Hinge	1
	Hager 1-479-0038 Wiring Harness	1
8B	Hager 4501 Rim Exit Device	1
	Hager 45CE X WTN X 3902 X KD Exit Device Trim Only	1
	Hager 5200 X MLT X 1-6 X 5203 X FC Closer	1
	Hager 2-679-0623 Electric Power Transfer	1
	Hager 780-224HD X EPT-2 X 83 OA Electric Continuous Hinge	1
9A	PHG ES500-ENTRY (F109) Cylindrical Lock	1
	PHG 4400 Closer	2
	Hager 282D Flushbolt Manual	1
9B	Hager 3453 X WITHNELL X 3944, SC X 3935 X KD X STD Cylindrical Lock with Thru Bolts	1
	Hager 5200 X MLT X 1-6 X 5203 X FC Closer	1
	Hager 282D Flushbolt Manual	1
10A	PHG HS500-ENTRY (F109) Cylindrical Lock	1
	PHG LU200 Cylindrical Dead Lock	1
	PHG 4400 Closer	2
	Hager 282D Flushbolt Manual	1
10B	Hager 3453 X WITHNELL X 3944, SC X 3935 X KD X STD Cylindrical Lock with Thru Bolts	1
	Hager 3115 X 3940 X 3930 X KD Cylindrical Dead Lock	1
	Hager 5200 X MLT X 1-6 X 5203 X FC Closer	2
	Hager 282D Flushbolt Manual	1
11A	PHG 25EDR Exit Device	1
	PHG L900- ENTRY (F08) Exit Device Trim	1
	PHG 4400 Closer	2
	Hager 282D Flushbolt Manual	1
11B	Hager 4501 Rim Exit Device	1
	Hager 45CE X WTN X 3902 X KD Exit Device Trim Only	1
	Hager 5200 X MLT X 1-6 X 5203 X FC Closer	2
	Hager 282D Flushbolt Manual	1
12A	PHG 89ED3684SVR SVR Exit Device	1
	PHG L900- ENTRY (F08) Exit Device Trim	1
	PHG 4400 Closer	2
12B	Hager 4501 SVR 0 36 X 84 X 1-3/4 SVR Exit Device	1
	Hager 45CE X WTN X 3902 X KD Exit Device Trim Only	1
	Hager 5200 X MLT X 1-6 X 5203 X FC Closer	2



Our UL10C testing journey has begun with fire-rated doors becoming available through 2026.

FIRE CERTIFICATION COMING SOON.



NOTES.

[illegible]



REGISTER INTEREST AS AN INSTALLER, DISTRIBUTOR OR WHOLESALE.



Scan the QR code here.

THERE'S NO COMPETITION



T: (630) 474-4677



sales@strongdor-usa.com



www.strongdor-usa.com



310 Windy Point Dr, Glendale Heights, IL 60139, USA